

Contents

	Page
Program & Venue Guide	2
Presentation Overview	7
Presentation Document	
Workshop	22
Networking	48

Program

Time	Topic	Venue
9:00 – 9:15	Opening session	
9:15 – 10:00	Session 1: Trilateral business cooperation in Thailand	Athenee Crystal Hall (3F)
10:00 – 12:35	Session 2: Cooperation in promising sectors	
12:35 – 13:15	Lunch	
	Networking session	
13:15 – 15:30	Transportation & logistics	London Room (2F)
	Energy & environment	Athenee Crystal Hall (3F)
	Smart city	Terrace Room (3F)

Venue Guide

ATHENEE CRYSTAL HALL
 3RD FLOOR, ATHENEE TOWER
 <W21 x L48.50 x HB M./ 1,020 SQ.M>

SCREEN SIZE:
 A - 4.50 x 6 M.
 B - 4.50 x 6 M.

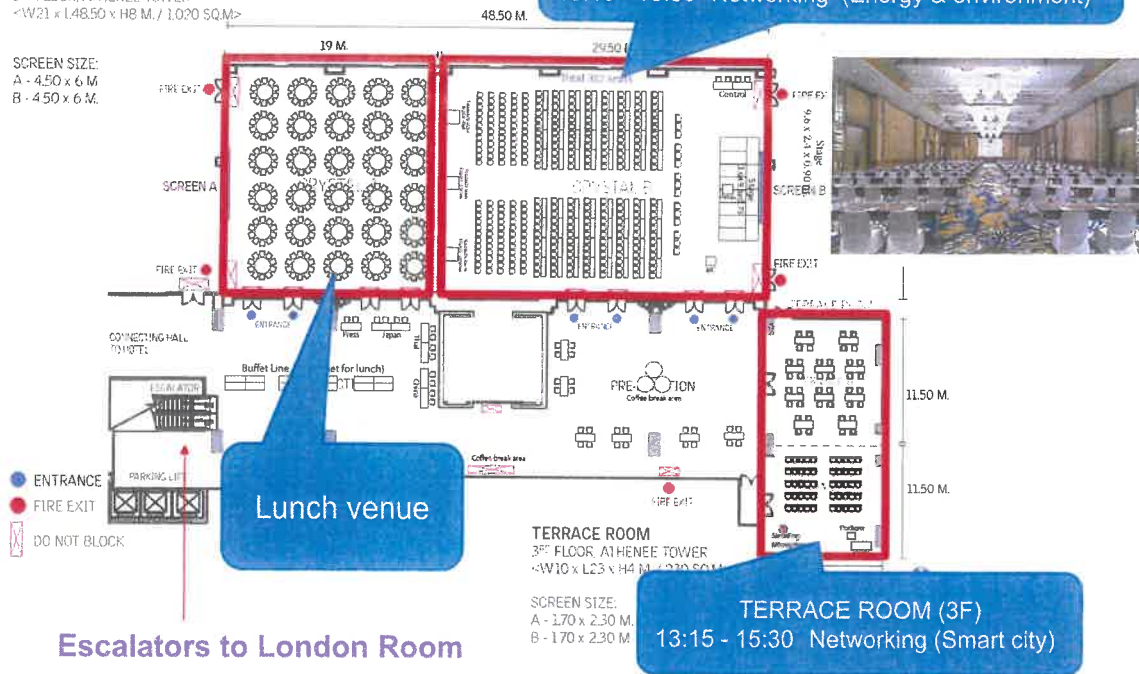

Escalators to London Room

Venue Guide

Escalators to Athenee Crystal Hall

LONDON ROOM (2F)
 13:15 - 15:30 Networking
 (Transportation & Logistics)

London Room I-II

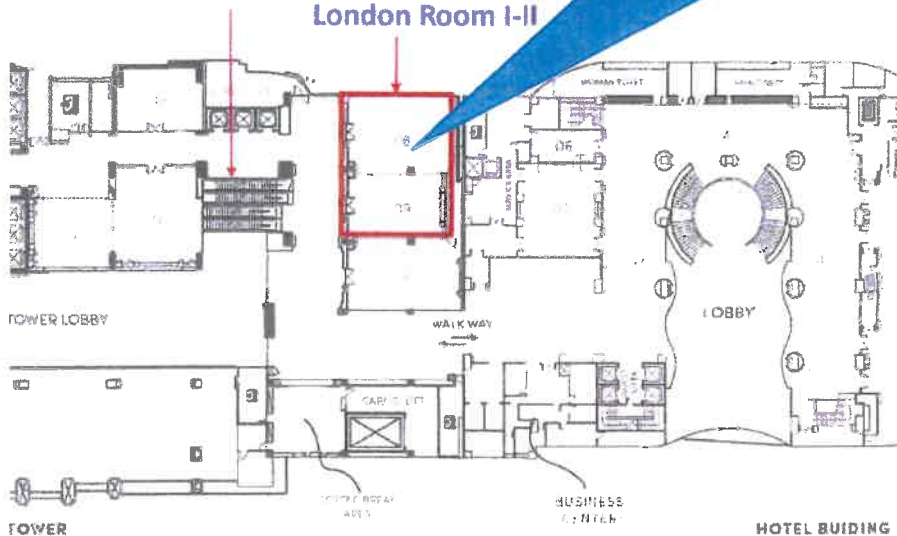

Program

5

Japan-China Workshop on Business Cooperation in Thailand

Time	Topic	Page
08:30 – 09:00	Registration	
	Opening Session	
	<u>Opening Remarks</u>	
09:00 – 09:05	Mr. Masaki Ishikawa, Director General, Trade and Economic Cooperation Bureau, METI	
09:05 – 09:10	Ms. Yu Haiyan, Deputy Director General of Department of Development Research of CCPIT	
	<u>Honorable speech</u>	
09:10 – 09:13	Mr. Shiro Sadoshima, Ambassador of Japan to the Kingdom of Thailand	
09:13 – 09:16	Mr. Lyu Jian, Ambassador of The People's Republic of China to the Kingdom of Thailand	
	Session 1: Trilateral Business Cooperation in Thailand	
	Development projects in EEC	
	<u>Keynote speech</u>	
09:16 – 09:30	Dr. Kanit Sangsubhan, Secretary-General, Eastern Economic Corridor Office in Thailand	
	<u>Photo session</u>	
09:30 – 09:40	1 st time : Government officials (VIPs) 2 nd time : VIPs and private sector speakers	
	<u>Presentation</u>	
09:40 – 09:50	Mr. Kenichi Aso, Resident Executive Officer - Regional Head for Asia and Pacific, Japan Bank for International Cooperation (JBIC)	
09:50 – 10:00	Mr. Li Zhigang, Chairman of the Board of Directors, Industrial and Commercial Bank of China (Thai) PCL	
	Session 2: Cooperation in Promising Sectors	
	<u>Introductory speech</u>	
10:00 – 10:05	Mr. Hiroki Mitsumata, President, JETRO Bangkok	
	(1) Transportation & Logistics	
10:05 – 10:15	Mr. Shinya Suto, Vice President, Nippon Express (South Asia & Oceania) Pte. Ltd.	
10:15 – 10:25	Ms. Li Jingjing, Vice President, Sany Heavy Industry Co., Ltd.	
10:25 – 10:35	Mr. Junji Miyawaki, Executive Vice President, Suntory Beverage & Food Asia Pte. Ltd.	
10:35 – 10:45	Mr. Ma Zhe, CEO, Deppon Logistics (Thailand) Co., Ltd.	
10:45 – 11:00	Coffee break	
	(2) Energy & Environment	
11:00 – 11:10	Mr. Tomonori Ishiguro, Managing Director, JERA Power (Thailand) Co., Ltd.	
11:10 – 11:20	Mr. Quan Nan, Director of Southeast Asia-South Asia Office, Global Energy Interconnection Development and Cooperation Organization (GEIDCO)	
11:20 – 11:30	Mr. Gen Takahashi, General Manager, Business Development, JFE Engineering Corporation	
11:30 – 11:40	Mr. Shengwen Xu, Vice Chairman, Talesun Technologies (Thailand) Co., Ltd.	

Japan-China Workshop on Business Cooperation in Thailand

Time	Topic	Page
	(3) Smart City Development in Thailand	
11:40 – 11:55	Mr. Vikrom Kromadit, Chairman, AMATA Corporation	
11:55 – 12:05	Mr. Koji Komai, Executive Advisor International Business Branch, Fujita Corporation	
12:05 – 12:15	Mr. Li Chuanzhao, General Manager, China Unicom Operations (Thailand) Co., Ltd.	
12:15 – 12:25	Mr. Somsak Garnjanakarn, Chief Marketing Director, General Manager, Hitachi Asia (Thailand) Co., Ltd.	
12:25 – 12:35	Ms. Liu Juan, Overseas Business Advisor of WeSmart Project Center, Tencent Holdings Group	
12:35 – 13:15	Buffet Lunch	
13:15 – 15:30	Networking Session (2 hour)	
	[Transportation & Logistics]	
	Mr. Yoichi Hirane, General Manager, Siam Nistrans Co., Ltd. Mr. Yoshihiro Kinoshita, Managing Director, Lao Nissin SMT Co., Ltd.	
	Mr. Chatinai Chodokruk, Business Development Manager, Anji-NYK Logistics (Thailand) Co., Ltd.	
	Ms. Ayano Ebashi, Manager, SG Sagawa (Thailand) Co., Ltd.	
	Ms. Tatsuda Thanathitinan, Office Manager, China Highwin (Thailand) Ltd.	
	Mr. Kosuke Yamamoto, Managing Director, Mayekawa (Thailand) Co., Ltd.	
	Ms. Gong Xue, Director of Operations, Deppon Logistics (Thailand) Co., Ltd.	
	[Energy & Environment]	
	Mr. Keiji Takimoto, General Manager, Osaka Gas Singapore Pte. Ltd.	
	Mr. Shan Xudong, Deputy Manager, China Petroleum Pipeline Bureau (Thailand) Co., Ltd.	
	Mr. Natee Katemanrom, Sales Manager, Miura Industries (Thailand) Co., Ltd.	
	Mr. Sarute Nark-Ngarm, Assistant Marketing Director, LONGi New Energy (Thailand) Co., Ltd.	
	Mr. Masaya Fujisawa, Sales Manager, IHI Asia Pacific (Thailand) Co., Ltd.	
	Mr. Maxwell Chen, General Manager, Growatt New Energy Technology (Thailand) Co., Ltd.	
	[Smart City]	
	Mr. Yoshi Ueno, TEPCO Energy Partner Incorporated	
	Mr. Zhang Dong, Enterprise Business Director, China Mobile International Limited Thailand Representative Office	
	Mr. Hirokazu Kawai, Sales Manager - Special Project, NMB-Minebea Thai Ltd.	
	Mr. Jonson Wu, COO, Thai Fintech Co., Ltd.	
	Mr. Geeravut Kong-On, IT Executive Officer, Command Trading Co., Ltd.	

Presentation Overview

7



Kanit Sangsubhan, Ph.D.
Secretary General
Eastern Economic Corridor Office of Thailand

Dr. KANIT is appointed as Secretary-General of the Eastern Economic Corridor Office of Thailand, also is the Chairman of the Executive Boards, Office of Knowledge Management and Development. Moreover, he takes the position of honorary academic advisor to the Fiscal Policy Research Institute, Ministry of Finance.

Earlier, Dr. Kanit has served as the Director of the Overall Planning Division at the National Economic and Social Development Board (NESDB) during 1996-1999. He also served as an Advisory Staff to Deputy Prime Minister and Minister of Commerce, Dr. Supachai Panitchpakdi during 1994-1996 and as an expert to the Standing Committee on Economics of the House of Representatives, Parliament of Thailand during 1996-1997. He later joined the Asian Development Bank Institute, Tokyo as a visiting scholar during 1999-2000.

In December 2000, Dr. Kanit joined the Fiscal Policy Research Institute, Ministry of Finance as the Director. He was a Member of Advisory Board for Asian Development Bank Institute in 2007 and a Member of Board of the TISCO Bank Ltd. in 2006-2008. He also serves as a Director of Dhanarak Asset Development Board, a position he has held since 2004. In addition, he was appointed as an Honorable Economic Advisor to Prime Minister in 2008. During 2009 – 2015, he served as Board of Director, Bank of Thailand and former the Chairman of National Health Security Financing Sub-Committee, National Health Security Office. In 2013, he has served as Chairman of the Board, Thai Smile Airways. Later, he served as Chairman of the Executive Committee Thai Airways during 2009-2017 and as State Railway of Thailand as Executive Vice President during 2016-2017.

Dr. Kanit holds a Ph.D. in Economics the University of Toronto, after receiving his Bachelors and Masters in Economics from Department of Economics, Thammasat University, Thailand.

Workshop

Keynote speech

Presentation Overview

00



Mr. Vikrom Kromadit
Chairman
Amata Corporation PCL

Education : Bachelor of Mechanical Engineering
National Taiwan University, Taipei, Taiwan

Present Position

2019 : Chairman of Amata Corporation PCL

1996 : Chairman of Amata Foundation

Present Activities

- : Chairman of Thailand-China Business Council
- : An Author whose books sold over 10millions copies
- : Philosopher
- : Broadcast programs on both radio and television

AMATA CORPORATION PCL. The group company started since 1975.

AMATA is World's leading industrial city developer. AMATA committed to creating a culture of ALL WIN by expanding new frontiers and exploring innovation to build a Smart City that enriches quality of life. We will explain about how we transform AMATA into a smart city which is a key cornerstone for Thailand 4.0 and EEC initiatives.

Workshop

Smart City

Presentation Overview



Mr. Kenichi Aso
Resident Executive Officer, Regional Head for Asia and Pacific
Japan Bank for International Cooperation (JBIC)

JBIC is a policy-based financial institution wholly owned by the Japanese government. We would explain the collaboration between JBIC and Chinese governmental financial institutions in third countries and explain the concept and prospects of Japan-China collaboration in third country, also introduce the recent activities in EEC project in Thailand.



Workshop

Development projects in EEC

P. 23-25



Mr. Shinya Suto
Vice President
Nippon Express (South Asia & Oceania) Pte. Ltd.

Nippon Express is a logistics company which expand own network over the world. We have more than 30 years history in Thailand after established. There are over 200 Japanese logistics companies in Thailand. We would introduce the overview of them and efforts to streamline and state an idea on the possibilities and directions of collaboration with Chinese logistics companies.



Workshop

Transportation & Logistics

P. 31-33



Mr. Junji Miyawaki
Executive Vice President, Head of Corporate Functions
Suntory Beverage & Food Asia Pte. Ltd.

Suntory Beverage & Food Asia has a business unit and manufacturing facility in Thailand and is planning to enter Chinese health food market from Thailand through utilization of e-commerce and another Chinese business unit in Suntory Group.

BRAND'S Suntory International is 100% affiliated manufacturing and sales company of Health Supplement under Suntory Beverage & Food Asia.



Workshop

Transportation & Logistics

P. 33-34

Presentation Overview



Mr. Tomonori Ishiguro
Managing Director
JERA Power (Thailand) Co., Ltd.

Jera

JERA is the joint corporation based on the comprehensive alliance entered into between Tokyo Electric Power Company (TEPCO) and Chubu Electric Power Company (Chubu). We will introduce Thai possibility of enhancing the value of Gas to Power, Smart Energy, etc., with making the best use of Chinese products, and with quality control and operation optimization by JERA and JERA-PT

Workshop

Energy & Environment

P. 36-38



Mr. Gen Takahashi
General Manager, Business Development
JFE Engineering Corporation



Our boundless missions are out there as long as the people in the world seek a more comfortable and better life. At the JFE Engineering Group, we will keep providing society with the optimal solution as a company that "creates and continues to care for the foundation for life."

Workshop

Energy & Environment

P. 39-40



Mr. Koji Komai
Executive Advisor International Business Branch
Fujita Corporation

FUJITA

 Daiwa House Group

Fujita is a Japanese construction company founded for over 100 years. A member of the Daiwa House Group. We will explain about Smart City Development projects in Thailand (AMATA Gateway Zone and AMATA Japan-China Joint Development Zone) and Japan-China-Thailand Joint Development project in Laos.

Workshop

Smart City

P. 42-45

Presentation Overview



Mr. Somsak Garnjanakarn
Chief Marketing Director, General Manager
Hitachi Asia (Thailand) Co., Ltd.

HITACHI
 Inspire the Next

Hitachi Asia continues to be contributed to Thailand 4.0 and EEC project that aims to drive Thailand forward and create value together with customers by Co-Creation based on MOU with EEC Office signed in 2017. Hitachi continues supporting smart manufacturing and will introduce smart logistics and smart city. For this event, we will explain about our smart city functions, systems, services and experience that will contribute in EEC and Thailand 4.0.

Workshop

Smart City

P. 45-47



Mr. Yoichi Hirane, General Manager
Siam Nistrans Co., Ltd.

Nissin group is a unique global logistics service provider in China, ASEAN, India, Americas and Europe.

"Hacolab", a cloud based application for "returnable boxes duty free operation" implements visualized inventory and history control for importer/ex



Mr. Yoshihiro Kinoshita, Managing Director
Lao Nissin SMT Co., Ltd.

Based on our experience of cross border logistics both by road and rail service in Indo-china, we will propose to Chinese partner for new generation of logistics service through new China-Laos railway.

 株式会社 日新
 NISSIN CORPORATION

Networking

Transportation & Logistics

P. 50



Ms. Ayano Ebashi
Manager
SG Sagawa (Thailand) Co., Ltd.

Taking advantage of Sagawa global network, we provide seamless international transportation: forwarding, storage, packing, and delivery. In the rapidly growing Asian market China and ASEAN, the demand of E-commerce is increasing also in Thailand. I introduce One-Stop Logistics service that we provide in Thailand and introduce business case and possibility of cross-border e-commerce that our Sagawa group is developing.

 SgH
 GLOBAL

Networking

Transportation & Logistics

P. 50-54

Presentation Overview



Mr. Kosuke Yamamoto
Managing Director
Mayekawa (Thailand) Co., Ltd.



As an industrial compressor manufacturer, we have long been involved in the food and cold distribution business in Thailand. As the economy grows in Thailand, a demand for cold chains is increasing in the society. On the other hand, there are many difficulties and tasks for the further development of the cold chain. As a manufacturer of industrial compressor and engineering company in the field, Mayekawa would like to share what are the obstacles and what need to be done. At the same time, I'd like to share how we can collaborate with Chinese companies.

Networking

Transportation & Logistics

P. 54-57



Mr. Keiji Takimoto
General Manager Business Development Team
Osaka Gas Singapore Pte. Ltd.



Established in 1905, Osaka Gas is expanding its business in Thailand, Singapore, Indonesia and other ASEAN countries. In the rapidly developing Thai market, we are keen to solve energy challenges of Chinese and Japanese companies as well as Thai companies so that they can expand their business in a coordinated way with Thai local.

Networking

Energy & Environment

P. 59-60



Mr. Natee Katemanrom
Sales Manager
Miura Industries (Thailand) Co., Ltd.



We have contributed to energy saving and reduction of environmental impact in China with our steam boiler Japanese technology of energy saving and reduction of environmental impact. In recent years, Thailand is facing pollution problem such as air pollution of PM2.5. We are eager to contribute to environment improvement in Thailand as well.

Networking

Energy & Environment

P. 61-65

Presentation Overview



Mr. Masaya Fujisawa
Marketing and Sales Manager
IHI Asia Pacific (Thailand) Co., Ltd.

IHI is the company contributing to the development of society through technology. We design and build progressive engineering solutions for customer. I will introduce outline of IHI Group established in 1853 and will explain business activity in Thailand and China. Then introduce a business example in collaboration with Chinese company in Southeast Asia.



Networking

Energy & Environment

P. 65-70

Mr. Yoshi Ueno
TEPCO Energy Partner, Incorporated

-



Networking

Smart City

P. 72-74



Mr. Hirokazu Kawai
Sales Manager, Special Project
NMB-Minebea Thai Ltd.

Minebea Mitsumi Smart City Solution are Energy saving by dimming. We are realizing our Smart City Solutions start with high quality wireless-controlled streetlights installation. We provide the dimming operation and maintenance services as well as devices. Our strength are below 3 points.

1. High quality streetlight <10 year lasting high quality product>
2. Energy saving <90% energy saving* by highly efficient power / LED and wireless dimming control. * Comparing to typical HID Mercury streetlights with the same rated luminous flux>
3. Future Expandability <Network / device management platform along with the roads all across the city.>



Networking

Smart City

P. 75-81

Presentation Overview



Mr. Li Zhigang
Chairman
Industrial and Commercial Bank of China (Thai) PCL

The largest commercial bank in the world in terms of market capitalization, acquired 97.24% of the total issued shares of the Bank from a voluntary tender offer of all shares traded on the SET and changed the name of the Bank to "Industrial and Commercial Bank of China (Thai) Public Company Limited" becoming a part of the ICBC Group.

Thailand shares close and friendly relations with China and Japan, which lays a solid foundation for multilateral cooperation. With the increase of investment from China to Thailand, the Chinese enterprises in Thailand are developing vigorously, which will render huge potential for international cooperation in the field of infrastructure and emerging industry among China, Japan and Thailand. Chinese banks including ICBC will seize the opportunity and give full support to all enterprises involved in EEC construction.

Workshop

Development projects in EEC



Ms. Li Jingjing
Vice President
Sany Heavy Industry Co., Ltd.

Founded in 1989, SANY has a comprehensive product profile, including concrete machinery, excavators, crawler cranes, rotary drilling rigs and coal mining machinery. Two of its member companies are listed on separate stock exchange markets: SANY Heavy Industry Co., Ltd.

SANY has been actively participating in the big engineering, big energy, big livelihood projects around the globe, including projects in Thailand and other ASEAN countries. SANY equipment can be seen in a lot of Thailand's key construction projects, i.e., the Airport Link, Light Rail Blue Line, Light Rail Red Line, the World's largest temple Tangmagai Temple, Thailand's tallest building Mahanakorn, etc. At present, SANY has more than 3000 sets of equipment in Thailand, among which the market share of new cranes reaches nearly 70%. Currently, SANY has developed five agents, one excavator joint venture, and one joint venture finance company in Thailand, establishing a relatively complete business system. In the future, SANY will continue to work with different sides to provide high-quality products as well as professional construction and financial solutions for our customers.

Workshop

Transportation & Logistics

Presentation Overview



Mr. Ma Zhe
CEO
Deppon Logistics (Thailand) Co., Ltd.

DEPPON LOGISTICS (THAILAND) Co., Ltd. specializes in Thailand-China land, air Logistics services and express customs declaration business, integrating professional warehousing, handling, import and export services.

In March 2017, Deppon established Deppon Logistics in Thailand. After a year of market practice, it gradually gained a full understanding of the Thai market. The presentation will focus on the Thailand Logistics market analysis, firstly, the problem of the Thai logistics market such as no standardized logistics division area, uncompleted logistics network, and lacking of logistics professions; and lastly the opportunities of investment in logistics in Thailand by applying China's experiences.

Workshop

Transportation & Logistics



Mr. Quan Nan
Director, Southeast Asia-South Asia Office
Global Energy Interconnection Development and Cooperation
Organization (GEIDCO)

The Global Energy Interconnection Development and Cooperation Organization (GEIDCO), is an international organization among willing firms, associations, institutions and individuals who are dedicated to promoting the sustainable development of energy worldwide.

The keynote speech focused on "Global Energy Interconnection". Building Global Energy Interconnection is a major innovation in the field of energy and power. It will create a clean energy-driven, electricity-centric, interconnected, and shared modern energy system. The allocation of wide-area and consumer electrification will fundamentally solve major problems such as resource shortage, climate change, environmental pollution, and powerless population, and open up new paths for accelerating world energy transformation and sustainable development. And GEIDCO is committed to promoting the construction of a Global Energy Interconnection, and has done a lot of work in strategy, planning, technology, and projects. GEIDCO is willing to actively build an international cooperation platform and unite all parties to jointly promote the transition of global energy and create a bright future for sustainable development of mankind.

Workshop

Energy & Environment

Presentation Overview



Mr. Shengwen Xu
Vice Chairman
Talesun Technologies (Thailand) Co., Ltd.

Suzhou Talesun Solar Technologies Co., Ltd. is a wholly owned subsidiary of Jiangsu Zhongli Group (SZ: 002309). Talesun Solar was established in 2010, and with an annual capacity of 4 GW cells and 5 GW modules, Talesun Solar has built the state-of-art, fully automated production line.

The development of photovoltaic solar energy will surely be an important part in the future's development of renewable energy. With the development of new technologies, the use of clean energy going to create a bright future. Talesun will continue to develop and work together to provide guarantees for the happiness for people of all countries.

Workshop

Energy & Environment



Mr. Li Chuanzhao
General Manger
China Unicom Operations (Thailand) Co., Ltd.

China United Network Communications Group Co. Ltd. ("China Unicom") established in January 2009 with the merger of former China Netcom and former China Unicom. China Unicom, ranked in Fortune Global 500, is the only Chinese telecom operator listed in the stock exchanges of New York, Hong Kong and Shanghai.

Abstract of the Speech:

1. Standardization of Smart City
2. How to monetize Smart City
3. What is the relationship between Smart City, 5G, AI, IoT and Cloud

Workshop

Smart City

Presentation Overview



Ms. Liu Juan
Overseas Business Advisor of WeSmart Project Center
Tencent Holdings Group

Workshop

Smart City



Mr. Chatinai Chodokruk
Business Development Manager
ANJI-NYK Logistics (Thailand) Co., Ltd.

ANJI-NYK logistics (Thailand) is an end-to-end automotive logistics provider which focuses on delivering finished vehicles and automotive spare parts. It is a joint venture company established on Oct 25, 2013 from three well-known and experienced logistics companies; SAIC ANJI Logistics, NYK Group and Yusen Logistics.

ANJI-NYK provides a wide range of services to support logistics services needs. With strong support from our business partners around the world, we provide our clients with full logistics services including air freight, ocean freight, cross border, and inland transportation with expertise in customs clearance process to all destinations across the world. Furthermore, we also focusing on container yard and warehousing management aiming at cost efficiency maximization of our clients. Last but not least, we are managing the flow of surplus, defective products, and recycling materials throughout our reverse logistics service.

Networking

Transportation & Logistics

Presentation Overview



Ms. Tatsuda Thanathitinan
Office Manager
China Highwin (Thailand) Ltd.

China Highwin (Thailand) Limited, known as CHLTH, a new generation Logistics Company. We arrange shipments from all of the major ports in China and in Thailand while providing competitive prices. We have dedicated professional staff around China and Thailand providing great Sea & Air freight service to most countries in the world.

This presentation consists of three main parts. The first part is the overview of CHLTH which includes a brief introduction, shows the history of the organization's development, and followed by the company's corporate structure. The second part is our corporate mission, where we share our vision to provide first class service across different countries and cultures. The last part is to show our long-term goals as well as potential future business opportunities around the world.

Networking

Transportation & Logistics



Ms. Gong Xue
Director of Operations
Deppon Logistics (Thailand) Co., Ltd.

DEPPON LOGISTICS (THAILAND) Co., Ltd specializes in Thailand-China land, air Logistics services and express customs declaration business, integrating professional warehousing, handling, import and export services.

The presentation is about the Smart Cabinet projection in Thailand. The growing logistics services and E-commerce market leads one of the main problems: the receipts. Only with digitizing and intelligentizing terminal express management, we can then solve the problem fundamentally and reduce labor and time costs. The smart cabinet consists of a physical container and an online transceiver system, which is connected with the terminal logistics to completely intelligentize the last piece of the logistics chain.

Networking

Transportation & Logistics

Presentation Overview



Mr. Shan Xudong
Deputy Manager
China Petroleum Pipeline Bureau (Thailand) Co., Ltd.

China Petroleum Pipeline Engineering Co., Ltd. (CPP) is committed to becoming a world-class, integrated storage and transportation service provider for oil and gas. We help our client every step of the way, from consultation, to surveying, to design, to procurement, to construction, to start-up, operation and maintenance; we also provide research and development services and machinery manufacturing.

The speech (presentation) is consist of three parts. The first part is CPP profile, which includes brief instruction, CPP qualification, capabilities and typical experience. The second part is the past cooperation experience between CPP and Japanese enterprises in Thailand, the last part is the CPP's interest and intend and potential business opportunity in Thailand..

Networking

Energy & Environment



Mr. Sarute Nark-Ngarm
Assistant Marketing Director
LONGi New Energy (Thailand) Co., Ltd.

LONGi New Energy (Thailand) Co., Ltd., wholly-owned subsidiary of Xi'An LONGi New Energy, has obtained the company certificates from Thai Government as an EPC services provider who mainly focus on providing Solar Roof-top services. Established in 2017, LONGi New Energy (Thailand) has been managing more than 14 local projects along with the cooperation of PEA ENCOM International Co., Ltd. as the investor of the projects.

Established in 2017, LONGi New Energy (Thailand) has been managing more than 14 local projects along with the cooperation of PEA ENCOM International Co.Ltd as the investor of the projects. Listed in Tier 1 by BNEF since 2016, LONGi is in 6th place by the latest classification in 1st quarter of 2019 and is the only one company on the top 10 which manufacturing only Monocrystalline. LONGi is also the world's largest Monocrystalline wafer manufacturer regarding to PV Tech's on-going analysis of global capacity expansion announcements. With 10 years of materials warranty and 25 years of efficiency warranty, every single product of LONGi is reliable and qualified. The efficiency degradation is less than 2% for the first year and less than 0.55% from the 2nd - 25th years. By spending 7% of total revenue on research and development, our true dedication on research and development has created the best selection for the renewable energy industry.

Networking

Energy & Environment

Presentation Overview



Mr. Maxwell Chen
General Manager
GROWATT New Energy Technology (Thailand) Co., Ltd.

Growatt is a new energy enterprise dedicated to the R&D and manufacturing of PV inverters including on-grid, off-grid and storage inverters, and user side smart energy management solutions as well. Growatt has shipped over 1.2 million inverters to over 100 countries and regions across the globe, growing into a Global Top 10 Inverter Brand and becoming the No.1 Chinese Residential PV Inverter Brand.

Presentation summary:

1. Briefly introduce Growatt company
2. Introduce Growatt Renewable products and solutions for Thailand market
3. Reference projects in Thailand.

Networking

Energy & Environment



Mr. Zhang Dong
Director
China Mobile International Limited Thailand Representative Office

China Mobile International is a wholly-owned subsidiary of China Mobile, headquartered in Hong Kong, responsible for the international business and services.

China Mobile's main business in Thailand are including providing services to Chinese enterprises and Chinese people in Thailand, proving ICT integration solutions for the enterprises, and introducing China's advanced industrial information application to Thailand..

Networking

Smart City

Presentation Overview



Mr. Jonson Wu
COO
Thai Fintech Co., Ltd.

Bee Box Technology (Thai Fintech is the parent company of Bee Box) founded in May 2018. Grand open in 29 December 2018. With the concept of developing smart locker technology for maximum utilization and make good experience with service technology for Smart life style.

Current the fast growing e-commerce business in Thailand as a result, the demand for express parcel delivery services is likely to increase and with the increasing amount of parcels causing problems in handling the parcels. From this issue, Bee Box realized the importance of solving the problem of parcel management by using the Bee Box Smart locker to help solve various problems of the delivery system working with service providers Logistics delivered to meet the parcel delivery service for efficient delivery of the first mile and last mile. And develop the Smart Locker technology to maximize the benefits to consumers by adding a variety of services to suit the current lifestyle of people.

Networking

Smart City

P. 82



Mr. Geeravut Kong-On
Executive Officer
Command Trading Co., Ltd. (Tencent holdings Group's Partner Company)

-

Networking

Smart City